

Baltic BALTIC745D-LW T

Art. no. BALTIC745DF-LWT
GTIN 7393069024319

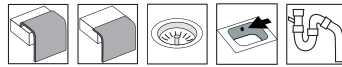

Cabinet size	80
Overall dimension in mm	745x440
Depth in mm	180
Bowl dim. in mm	347,5 x 400 x 180
Cut-out dimension, inset model	725 x 420
Waste hole dim. in mm	3½"
Material	EN 1.4301, AISI 304, SS2333
Material thickness in mm	1,2
Gross weight in kg	10.00
Net weight in kg	7.25
Pcs per pallet	10

Description

Baltic square kitchen sink, 2 bowls with thin and low divider wall, for flush and under mount. The low divider wall allows the use of either two separate bowls, or the entire sink when washing large oven trays for example.
Delivered with basket waste, overflow and water trap.
Without clips.
Separate article number for flush mount with clips:
Baltic745DF-LWT

Optional

