

VOLA 060 & 060A

Fitting instruction  
 Montageanleitung  
 Monteringsvejledning  
 Montageanleitung  
 Manuel de montage

Data	Bar:	1	2	3	4	5
(l/min)		12	18	22	25	29
(Gal/min)		3.4	4.8	5.8	6.6	7.7

Max. 65°C. 150°F

**VR161 - 060, 060A:**  
 VR161K: 1.8 Gal/min - 7 l/min  
 VR161D: 2.5 Gal/min - 9 l/min  
 VR161F: 3.7 Gal/min - 14 l/min

3 + 10

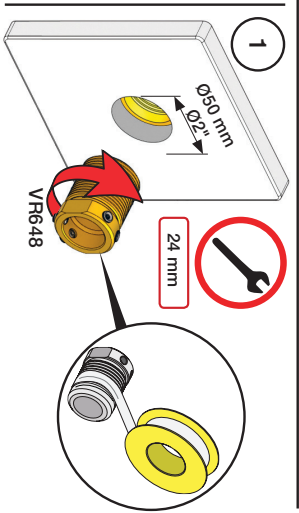
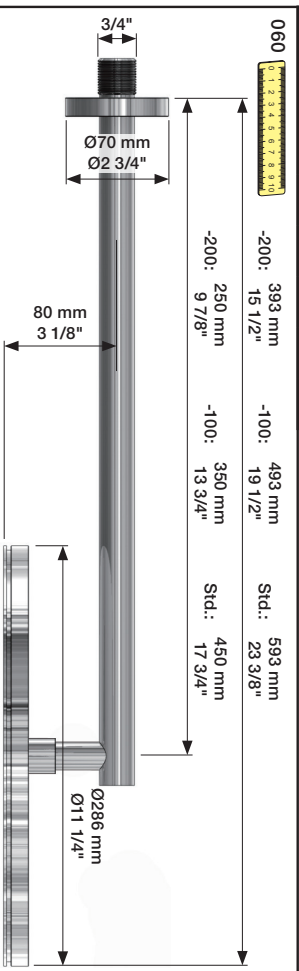
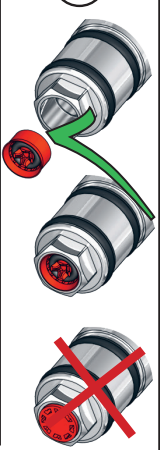

1 - 6 + 11

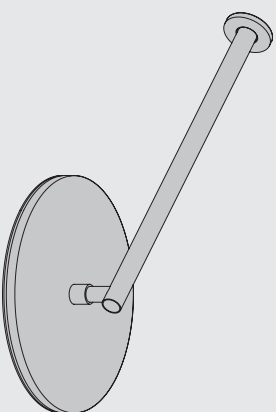

2

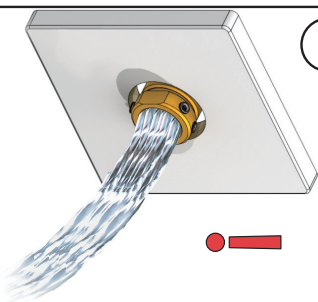

3

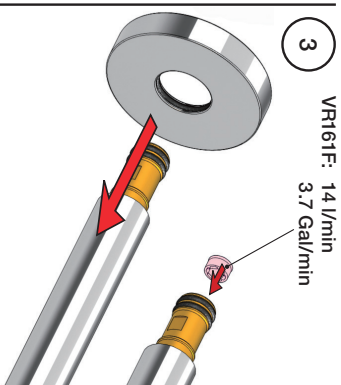

4

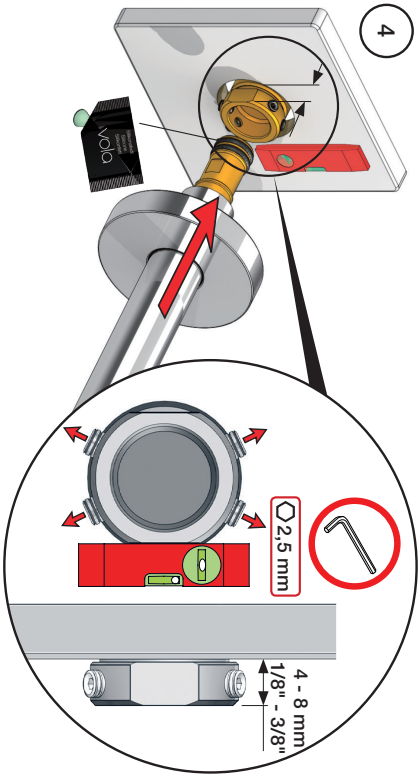

7 - 11

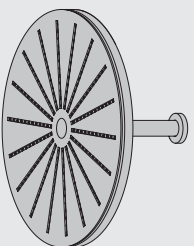

5

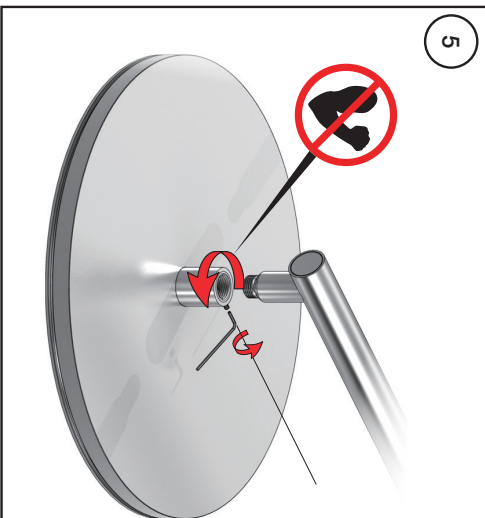

6 + 11

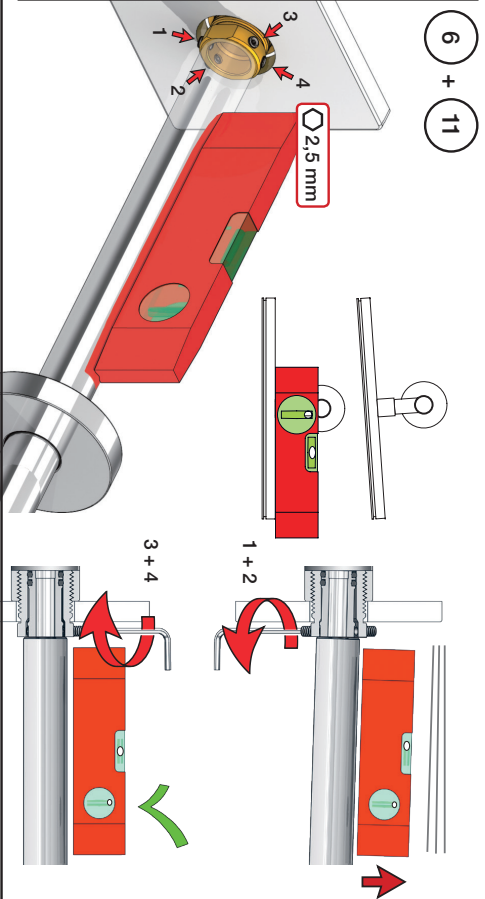

060A:

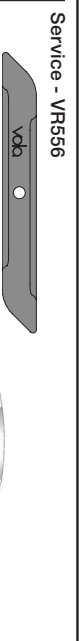
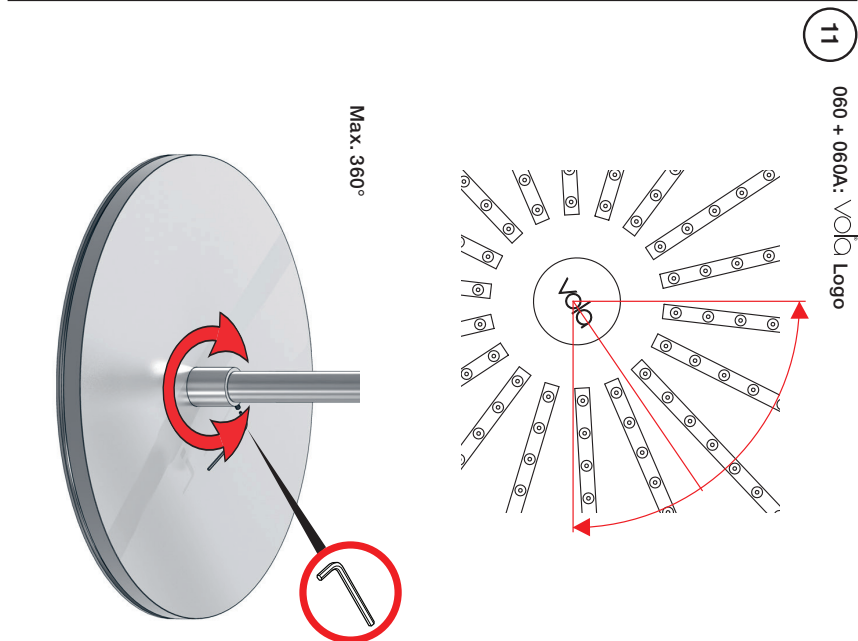
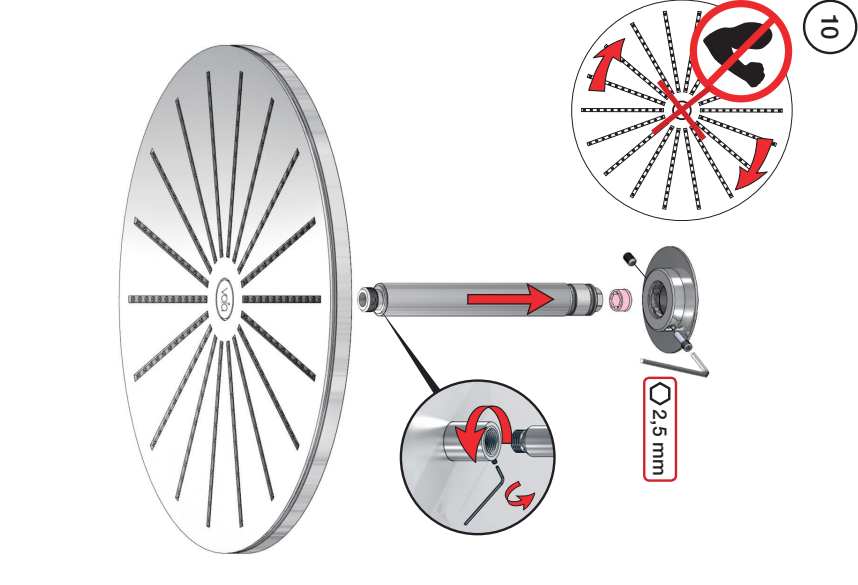
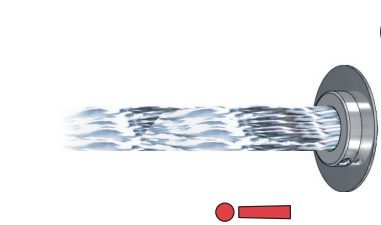
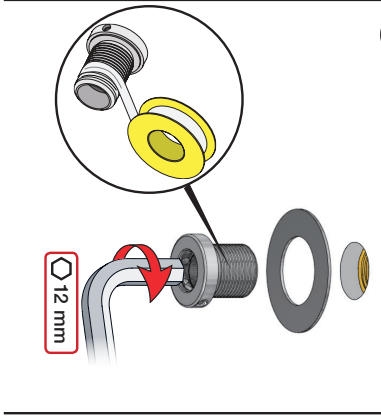
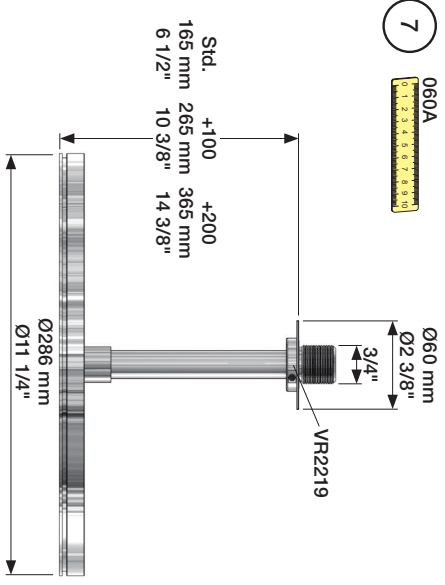

Extension Verlängerung	Forlängerdelen Förlängning	Verlängningsstücken Modification
VR648:	VR648:	VR2219:
3 - 19 mm	Standard	3 - 15 mm
17 - 28 mm	VR648+10	15 - 25 mm
27 - 38 mm	VR648+20	25 - 35 mm
37 - 48 mm	VR648+30	35 - 45 mm
47 - 58 mm	VR648+40	45 - 55 mm
57 - 68 mm	VR648+50	55 - 65 mm
		VR2219+50

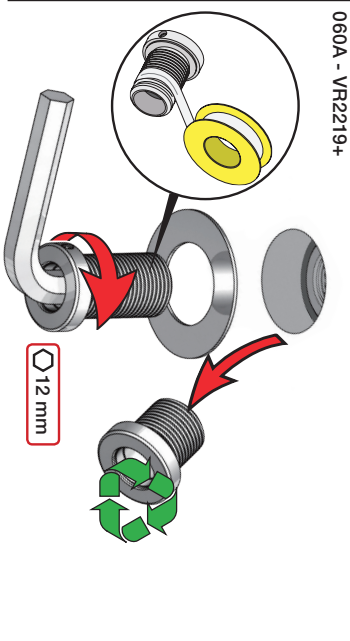
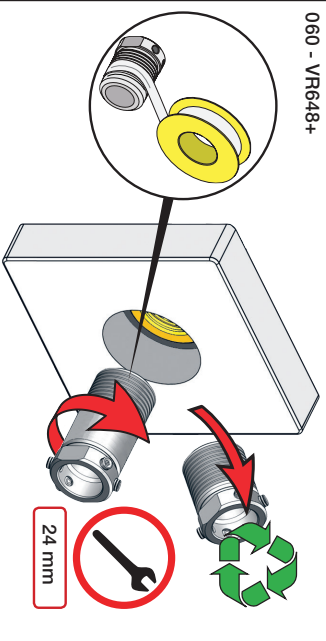



Monteringsvejledning  
Montageanleitung  
Manuel de montage

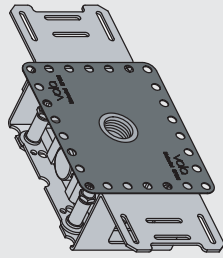

www.vola.com  
200M\_V00\_40986991



vola

5 1703182 430669

00

Installation example  
Installationsbeispiel

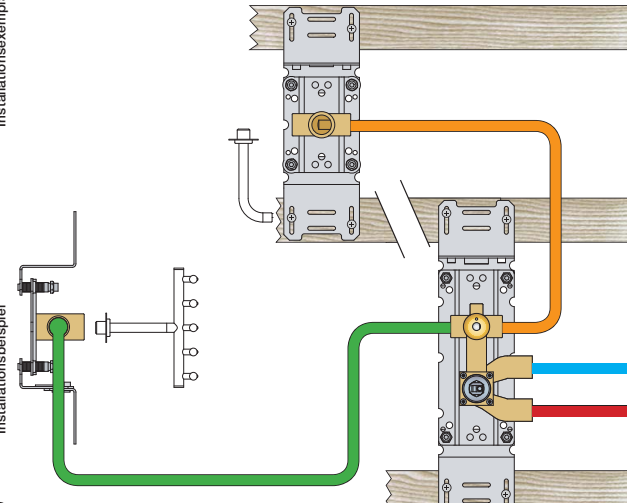

Installatie voorbeeld  
l'installation des exemple

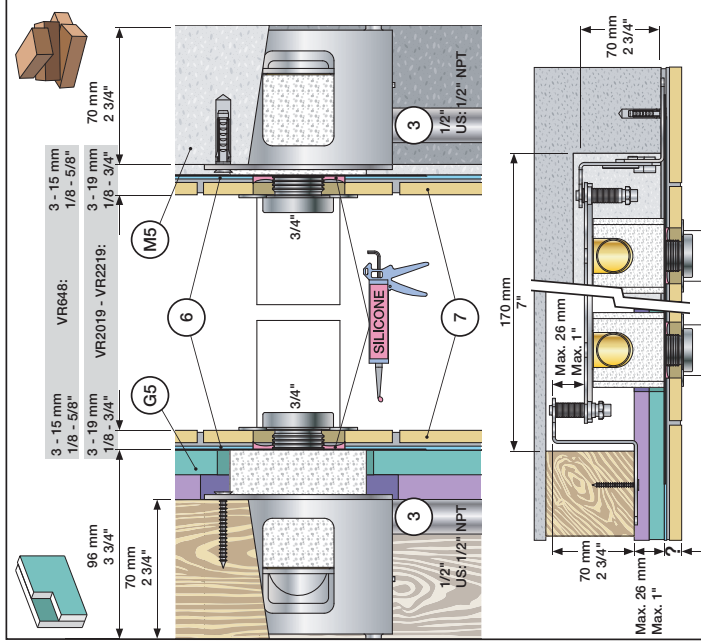
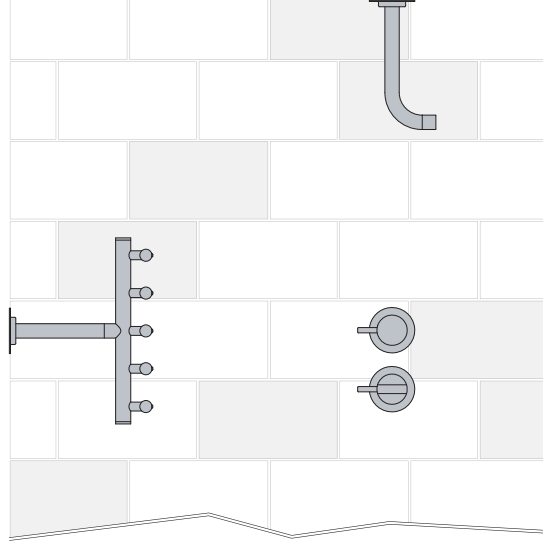

**Extension  
Verlängerung**

VR2019: 010, 020, 030, 040/B, 050K,  
070R/S/W, 080/K/D/DK  
VR2020: 080W  
VR2119: 010C, 020C, 040D  
VR2219: 050, 050A, 060A  
VR648: 060, 080ST

**Verlängerstücken  
Modification**

VR648

VR2019, VR2119  
VR2020, VR2219

Tiles:	3 - 15 mm	Std.
Fliesen:	15 - 25 mm	+10
Flieser:	25 - 35 mm	+20
Teglals:	35 - 45 mm	+30
Carreaux:	45 - 55 mm	+40
	55 - 65 mm	+50

Tiles:	3 - 19 mm	Std.
Fliesen:	17 - 28 mm	+10
Flieser:	27 - 38 mm	+20
Teglals:	37 - 48 mm	+30
Carreaux:	47 - 58 mm	+40
	57 - 66 mm	+50

VR2019 - VR2219:

- Std. 26 mm
- +10 36 mm
- +20 46 mm
- +30 56 mm
- +40 66 mm
- +50 76 mm

VR648:

- Std. 70 mm
- +10 80 mm
- +20 90 mm
- +30 100 mm
- +40 110 mm
- +50 120 mm

**Fitting of extension  
Montage von verlängerung**

**Montering af forlængerdele  
Montering av förlängning**

**Montage van de verlängerstukken  
Montage des rallonges**

VR2019+, VR2119+  
VR2020+, VR2219+

VR648+

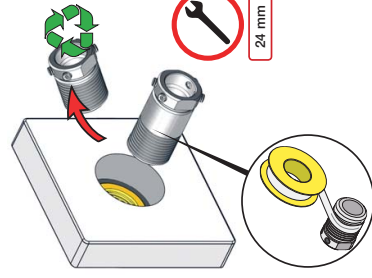
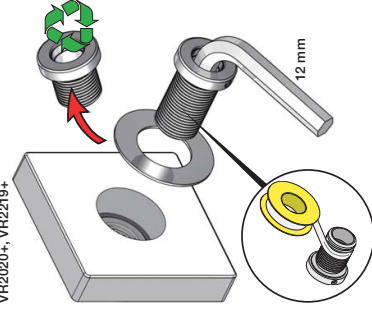

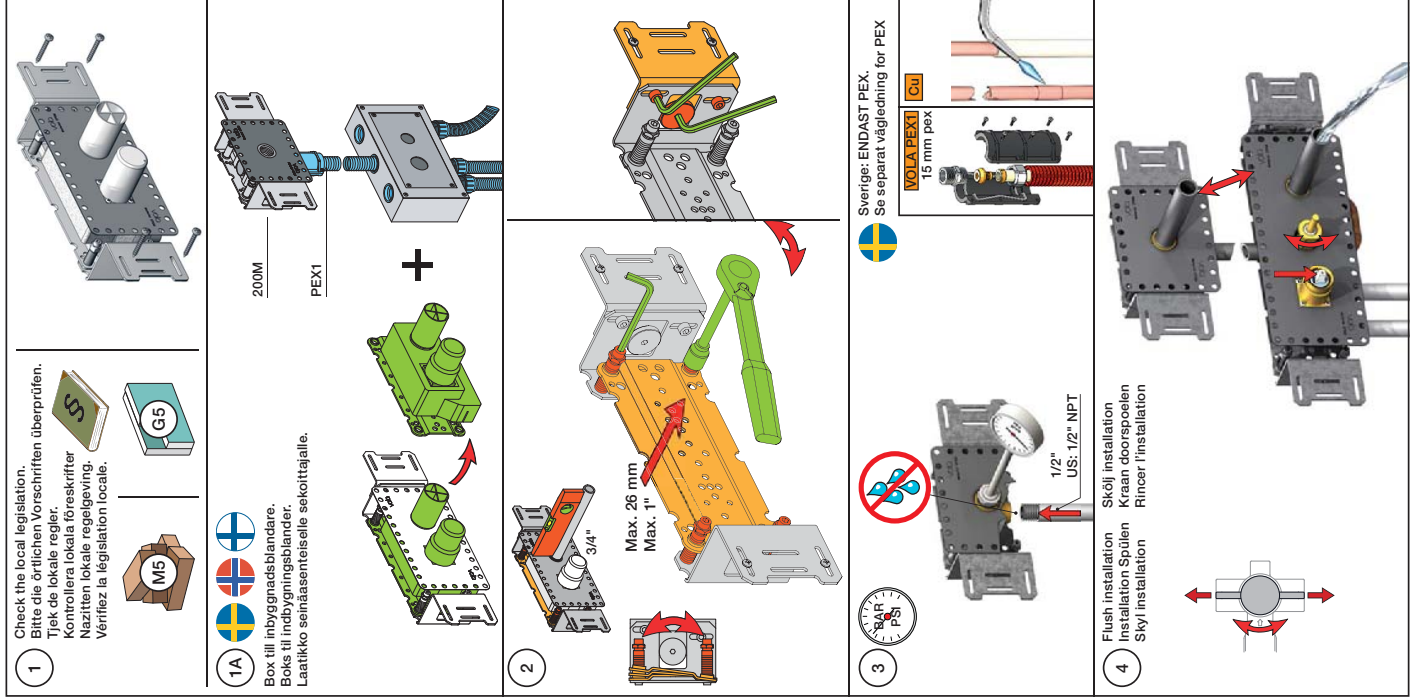
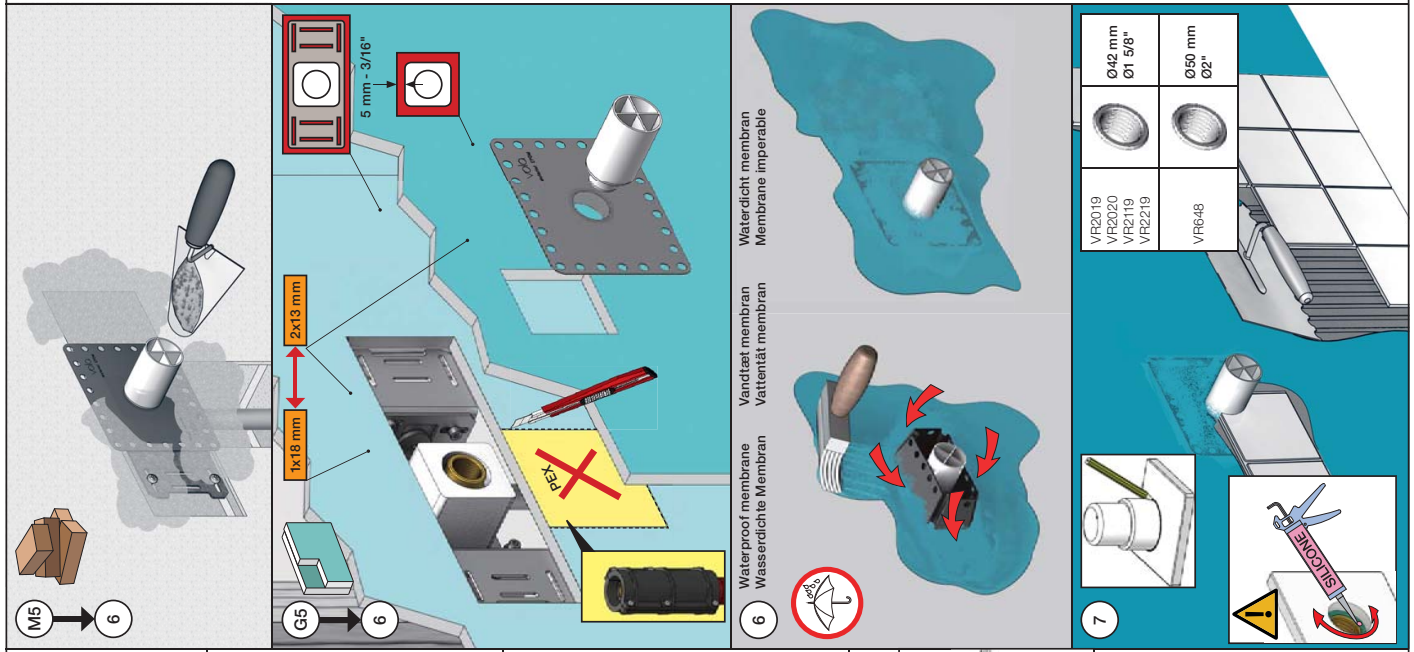
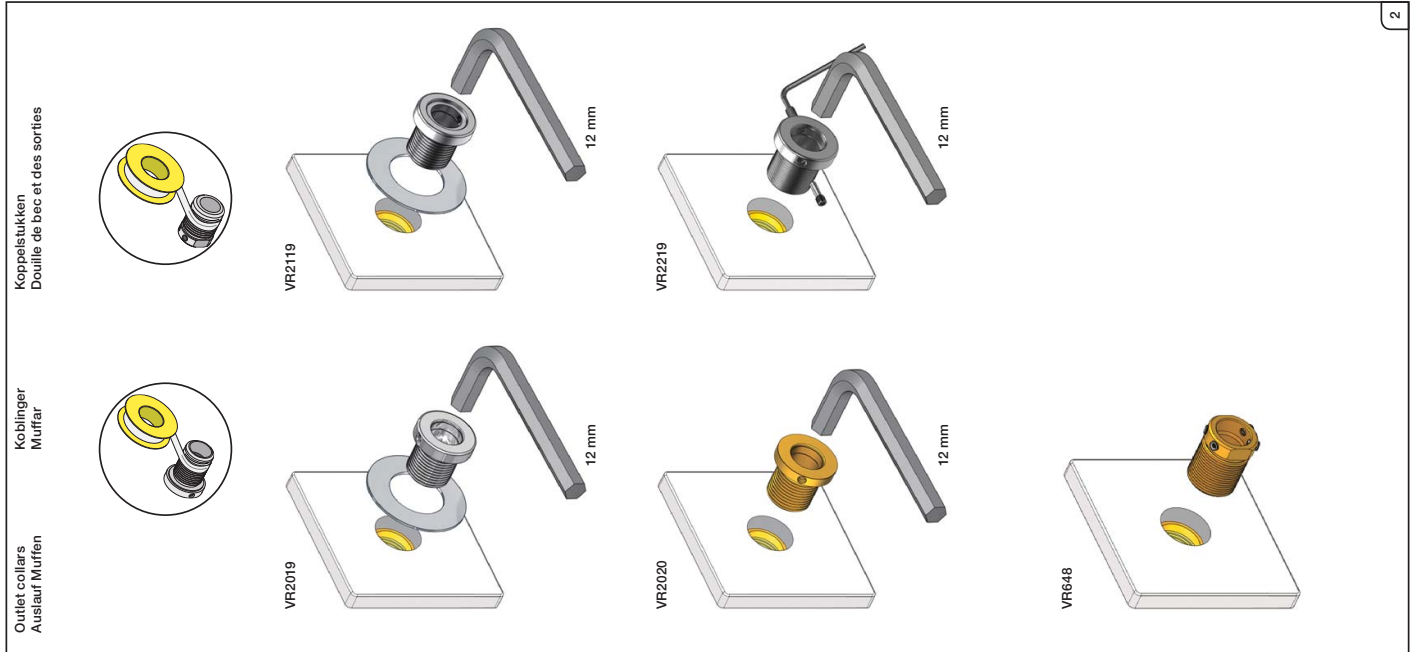

VOLA 100, 100X, 200, 200V, 300  
 VOLA 400DV, 400, 400V, 400N, 400NV, 400T  
 VOLA 400TV, 400F, 400FV, 400R, 400RV  
 VOLA 2100, 2100X, 2200, 2200V, 2300, 2400  
 VOLA 2400V, 2400N, 2400NV, 2400T, 2400TV  
 VOLA 2400F, 2400FV, 2400R, 2400RV

Fitting instruction  
 Montageanleitung  
 Montagehandleiding  
 Monteringsvejledning

Montagevejledning  
 Montage handleiding  
 Manuel de montage

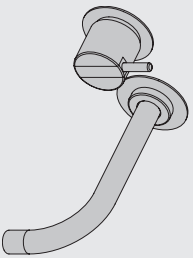
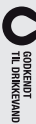

www.vola.com  
 100-2100\_V11\_40999996



A	L	L1	L2	L3	L4	L5	H	H1
395 mm	280 mm	129 mm	207 mm	-	-	-	130 mm	120 mm
15 1/2"	10"	8 1/8"	8 1/8"	-	-	-	4 3/4"	4 3/4"
		234 mm	9 1/4"	54 mm	76 mm	-	-	-
		189 mm	7 1/2"	2 1/8"	3 1/8"	-	1 7/8"	1 7/8"
		535 mm	130 mm	-	-	79 mm	3 1/8"	120 mm
		435 mm	5 1/2"	-	-	156 mm	6 1/8"	4 3/4"
		570 mm	1 7/8"	-	-	6 1/8"	-	-

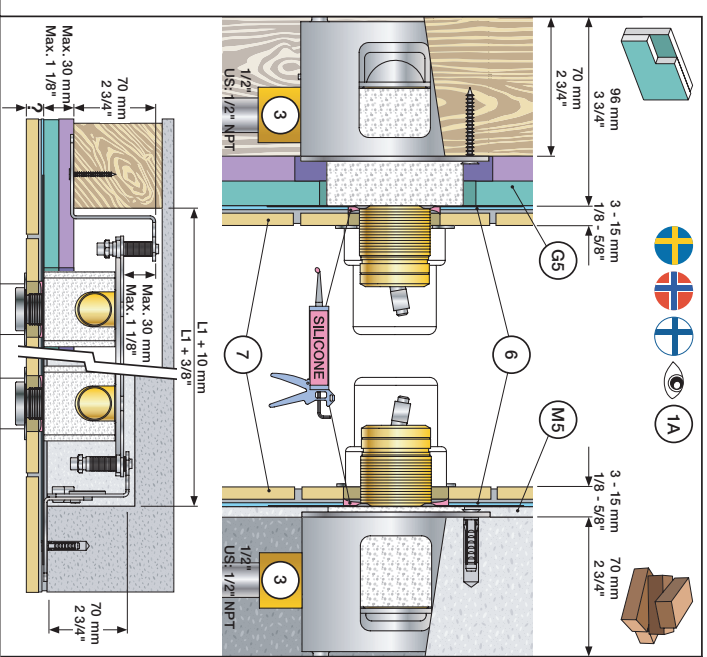
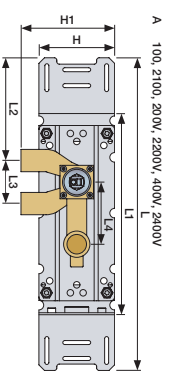
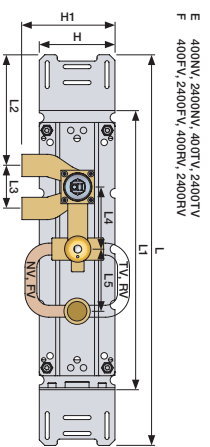
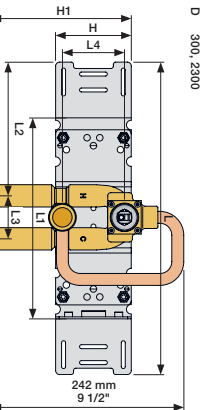
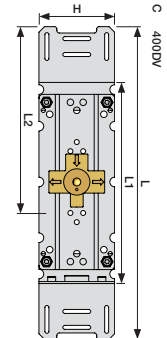
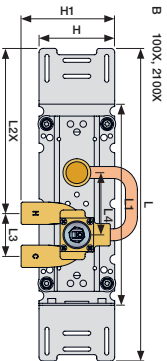

**Data: 3 Bar/43.5 Psi**

Im/m.	Gal/mim.	Max. 65°C, 150°F
100:	18,3	4,1
400V:	15,6	4,8
2100:	25,2	6,7
2400V:	22,2	5,9

**Max.: 10 Bar/145 psi**

DE:  
 Bitte separat beiliegende Anleitung für die Schalldämpfer VR1249 beachten

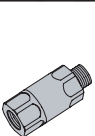

Extension Verlängerung	Fortlängerte Forthängende	Veranstücken Modification	VR2019	VR2019	VR2019
100/200/300/400	VR1264	VR1400	Sid.	Sid.	Sid.
3-15 mm	Sid.	+10	+10	+10	+10
15-25 mm	+10	+20	+20	+20	+20
25-35 mm	+20	+30	+30	+30	+30
35-45 mm	+30	+40	+40	+40	+40
45-55 mm	+40	+50	+50	+50	+50
55-65 mm	+50	+50	+50	+50	+50

Extension, retrofit Fortlängerte, eftermontering Forthänging, eftermontering Ampassning på montage Modification après installation	VR2019	VR1400	VR2019	VR2019
100/200/300/400	VR1264	VR1400	VR2019	VR2019
40-52 mm	Sid.	Sid.	Sid.	Sid.
30-40 mm	+10	+10	+10	+10
20-30 mm	+20	+20	+20	+20
10-20 mm	+30	+30	+30	+30
0-10 mm	+40	+40	+40	+40
-10-0 mm	+50	+50	+50	+50

**Fitting of extension  
Montage von verlängerung**

**VR1264+**

**VR2250+**

**VR2019+, VR2119+**

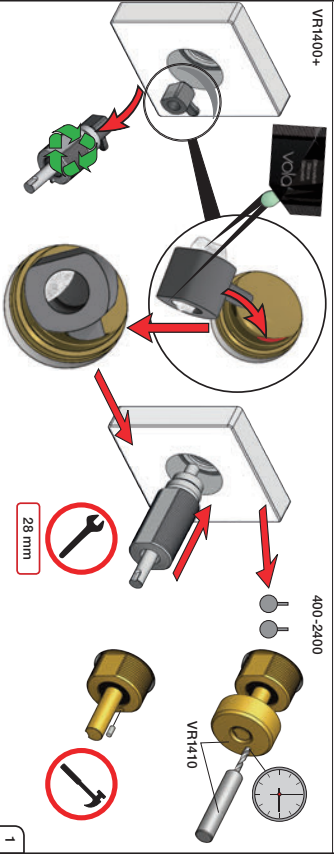
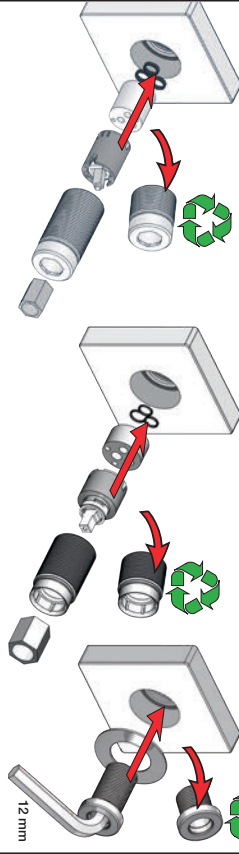

1 Check the local legislation.  
 Bitte die örtlichen Vorschriften überprüfen.  
 Tjek de lokale regler.  
 Kontrollera lokala föreskrifter  
 Nazhitten lokalni regulacije  
 Vérifiez la législation locale.

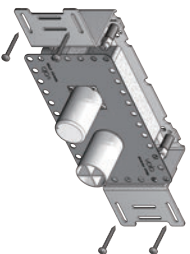

1A Box till inbyggna bändare.  
 Boks till indbygningsskander.  
 Laatikko seinäasennukselle sekottajalle.

Ingrä inte i leveransen  
 köps separat.  
 Ikke inkluderet, kjøpes  
 separat.

Eivät sisälly tiliinseen,  
 ostettava erikseen.

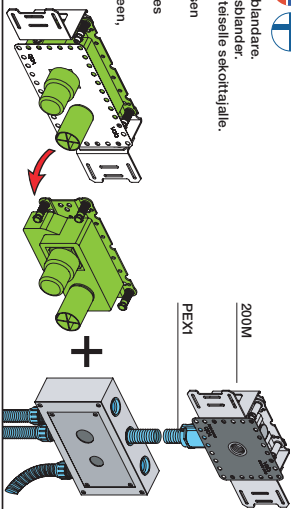

2

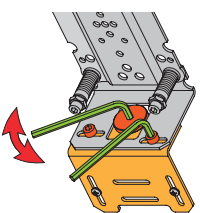
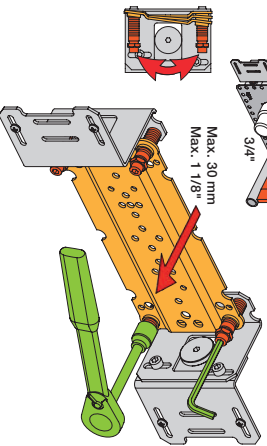

3 PS1

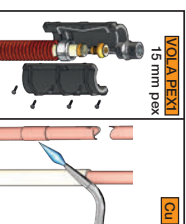
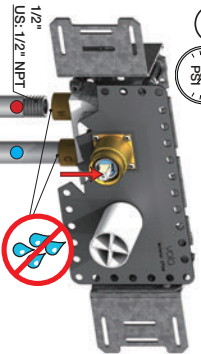

Sverige: ENDAST PE-X.  
 Se separat vägledning för PE-X

4 Flush installation  
 Skål installation  
 Kran doorspoelen  
 Rinser installation

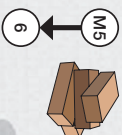
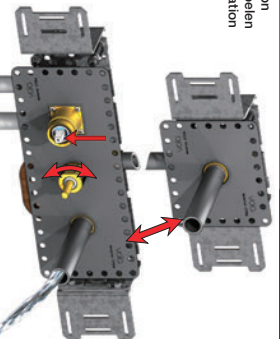
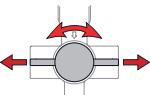

M5

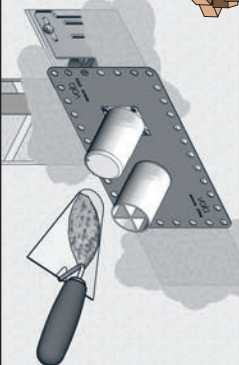

G5

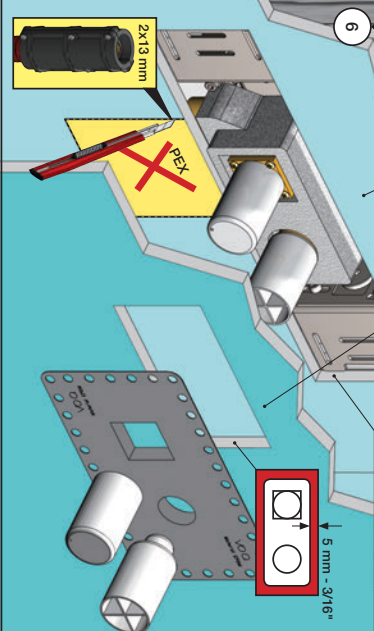

6 Waterproof membrane  
 Wasserdichte Membran  
 Vattentät membran  
 Membranticht  
 Membrane imperable

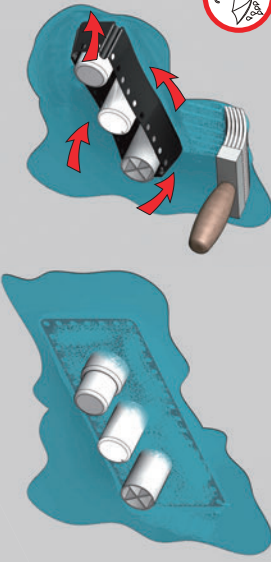

7

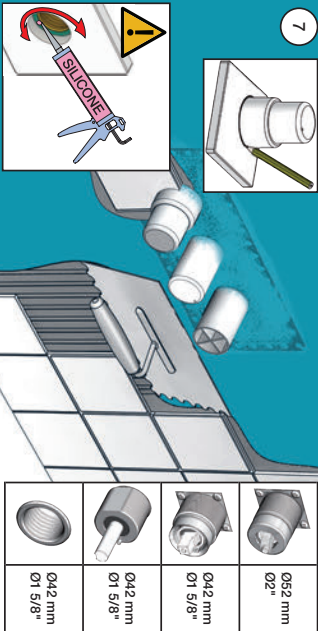

Hande assembly  
 Montage vom Griff

Montage af greb  
 Montering av grepp

Instalatie van de grip  
 l'installation de poignées

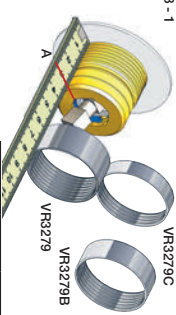

VR3279C	A
VR3279	16 mm 31 - 36 mm
VR3279B	12 mm 27 - 32 mm
VR3279C	8 mm 23 - 28 mm

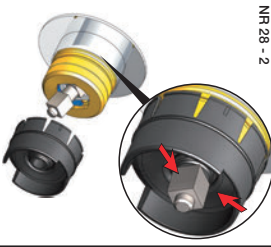

NR 28 - 3

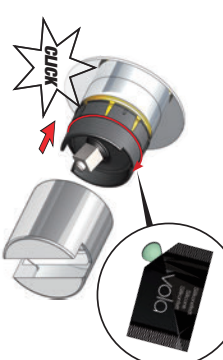

VR2279C	A
VR2279	16 mm 30 - 34 mm
VR2279B	12 mm 26 - 30 mm
VR2279C	8 mm 22 - 26 mm

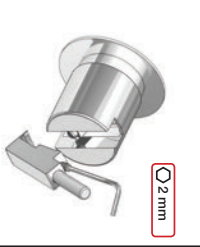

NR 21 - 1

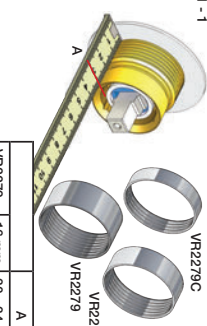

NR 21 - 3

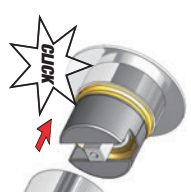

VR2204C	A
VR2204	16 mm 16 - 21 mm
VR2204B	12 mm 11 - 17 mm
VR2204C	8 mm 7 - 13 mm

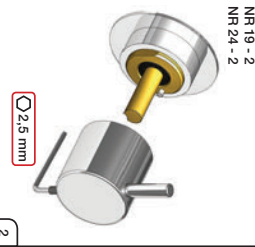

NR 19 - 1

NR 19 - 2

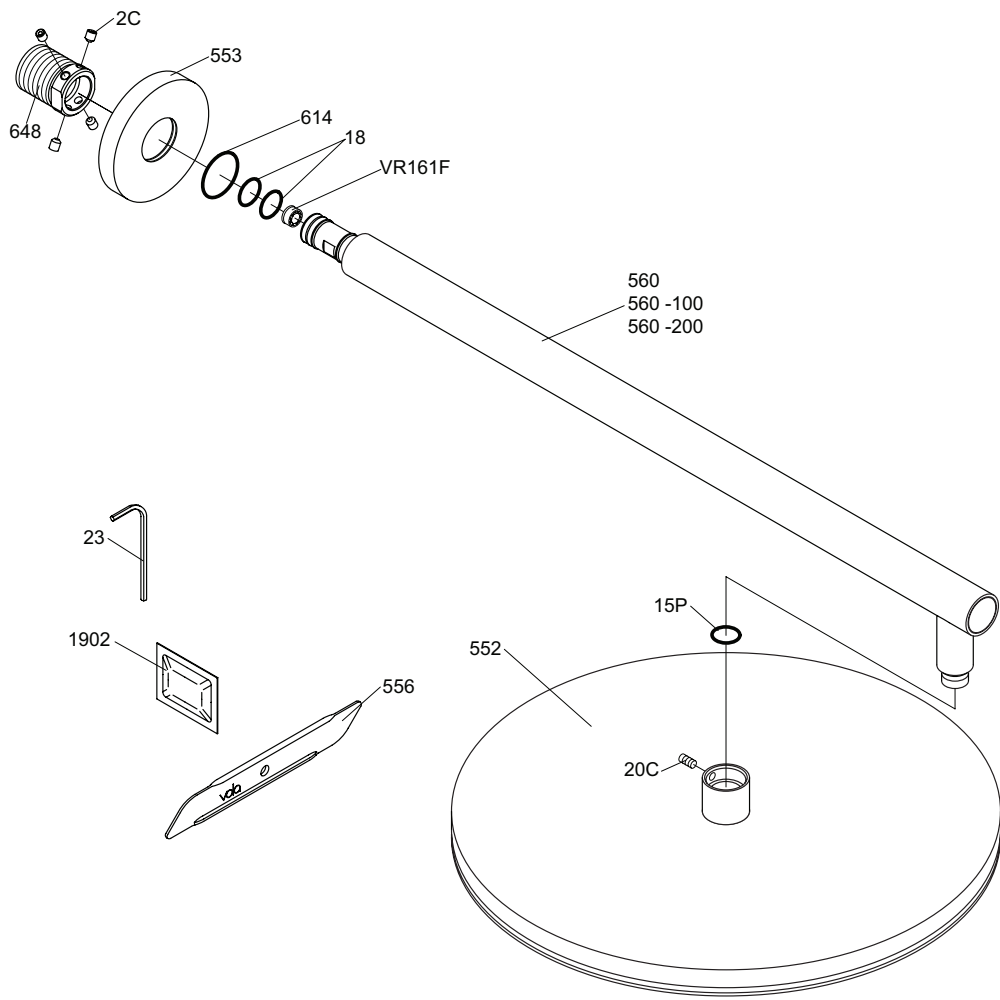

**vola**  
 Lunavej 2  
 DK-8700 Horsens  
 Tlf : + 45 7023 5500  
 Fax: + 45 7023 5511  
 sales@vola.com  
 www.vola.com

# VOLA 060

Date  
mar. 14

Rev.  
1

Sheet  
**SB 15.1**

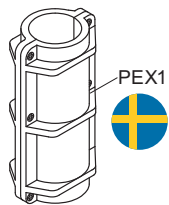
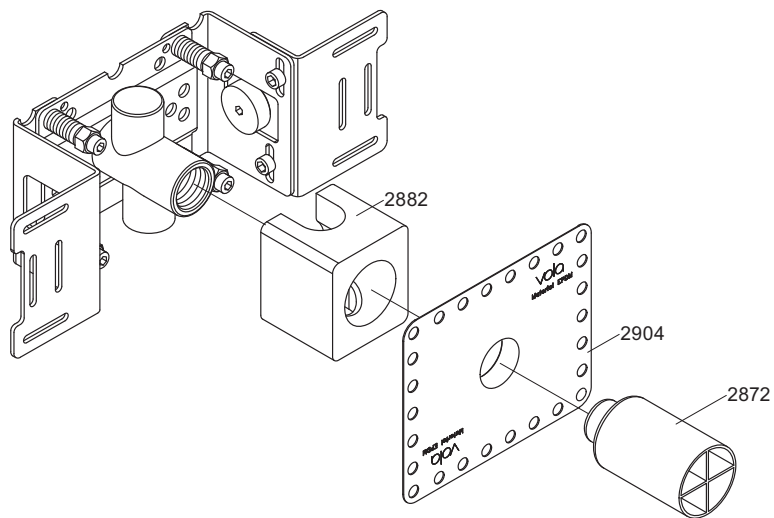

**vola**  
 Lunavej 2  
 DK-8700 Horsens  
 Tlf : + 45 7023 5500  
 Fax: + 45 7023 5511  
 sales@vola.com  
 www.vola.com

## VOLA 200M

Date  
Jan. 10

Rev.  
2

Sheet  
**SB 2.3**



2100

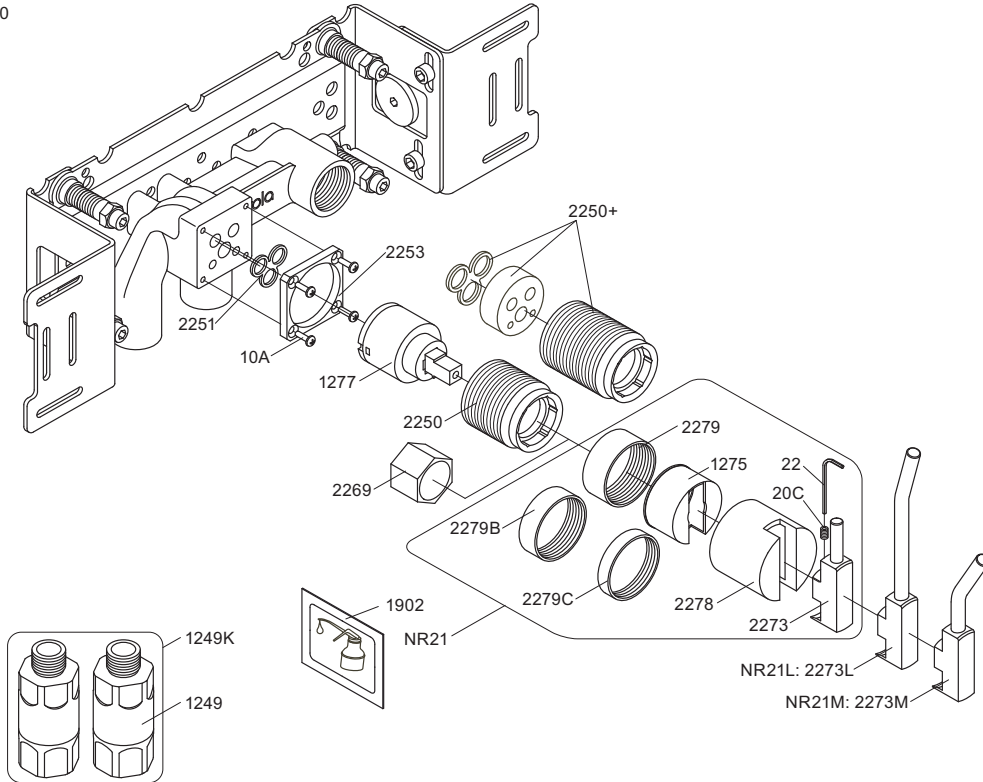

NR21: VR020C, VR22, VR1275, VR2269, VR2273, VR2278, VR2279, VR2279B, VR2279C  
 VR1277K: VR22, VR1277, VR2269

2100

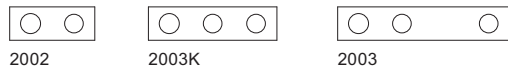
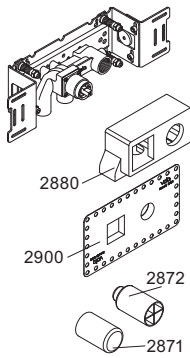

2100X

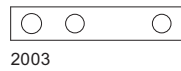
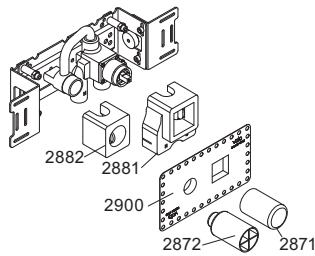

2200V

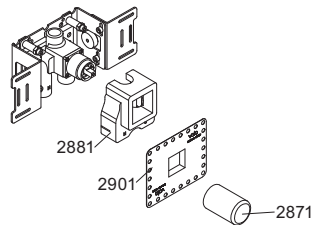

2300

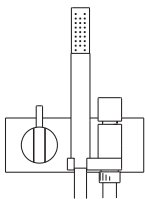
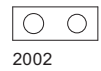
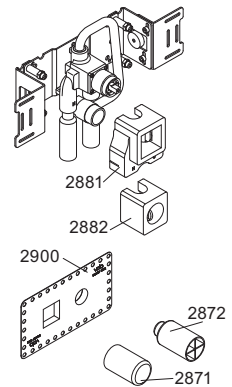

**VOLA A/S**  
 Lunavej 2  
 DK-8700 Horsens  
 Tlf : + 45 7023 5500  
 Fax: + 45 7023 5511  
 sales@vola.com  
 www.vola.com

**VOLA 2100**  
 2100X, 2200V, 2300

Dato

Feb. 10

Rev.

1

Blad

SB 10.7